

A.

**Reymond Products International, Inc.
Die Order Form**

Concave Ends: _____ Concave Top: _____ Concave Bottom: _____
Convex Ends: _____ Convex Top: _____ Convex Bottom: _____

* Number of 1-1/4" die frames (not including front section) ____ * Length of front section liner: 1-1/4" ____ 2-1/2" ____

Information to Stamp Here
ie...modular, smooth,
utility, kingsize, etc...

Cap Texture:

Smooth:

Velour:

Radius Corner

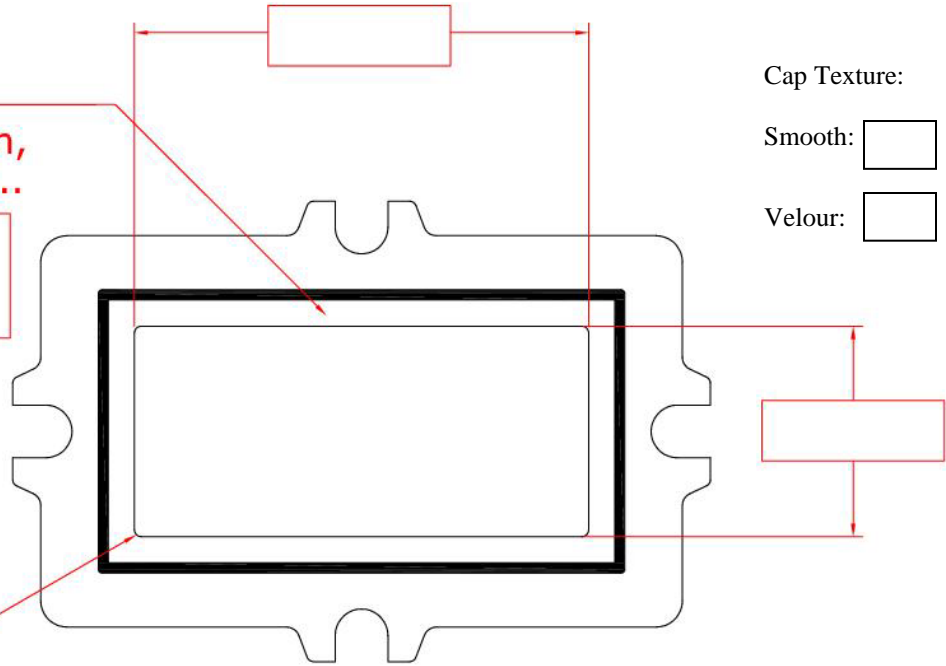

Die

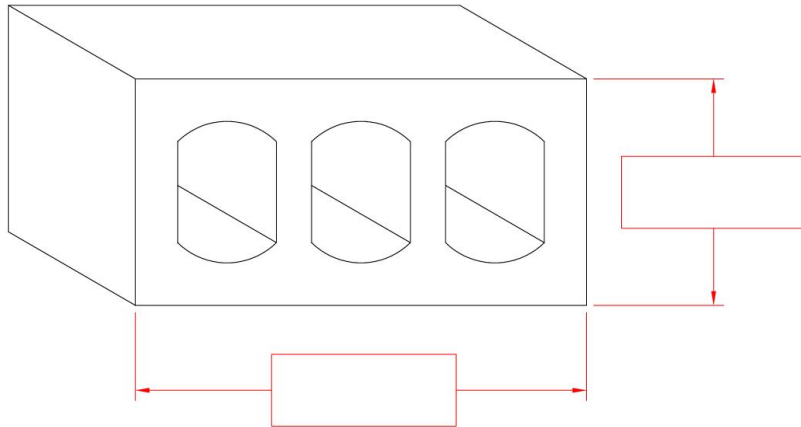

Final Trim Size

*Note: If ordering a Die only,
please note Center Forming
Section Opening on attached page.

Note: If velouring, please
give trim-to-size in boxes to
the left.

* Not Applicable for New Customers

Fax: 330-339-6809
Phone: 330-339-3583